



**UAC VISTABORD / UAC FLEXABORD
FLATBOARD SERIES**

Vistabord

Flexabord



UAC Vistabord and UAC Flexabord are both premium boards made for the exclusives who only want the best. UAC Vistabord is a sanded, smooth-surfaced board with a recessed edge, whereas UAC Flexabord is an unsanded-surfaced board with a recessed edge.

The recessed edge profile makes UAC Vistabord and UAC Flexabord the ultimate flush-jointable boards for creating seamless joints and transforming an entire wall or ceiling into a smooth, flat surface. UAC Vistabord and UAC Flexabord are the perfect combination of exclusive design and material strength.

APPLICATIONS

- Façade
- Gable End
- Internal Wall Lining
- Drywall
- Ceiling
- Soffits
- External Wall Cladding
- SolidWall

IMPERIAL

Dimensions (mm)	Nominal Weight (kg)
2440 × 1220 × 6.0	27.0
2440 × 1220 × 9.0	40.5
2440 × 1220 × 12.0	53.9

METRIC

Dimensions (mm)	Nominal Weight (kg)
2400 × 1200 × 6.0	26.1
2400 × 1200 × 9.0	39.1
2400 × 1200 × 12.0	52.2



PRODUCT DESIGNS



A pinkish, sanded, smooth-surfaced, recessed edge board.



A pinkish, unsanded, smooth-surfaced, recessed edge board.

CEILING

A. TYPICAL DETAIL FOR INTERNAL CEILING SYSTEM (CLIP FIXED)

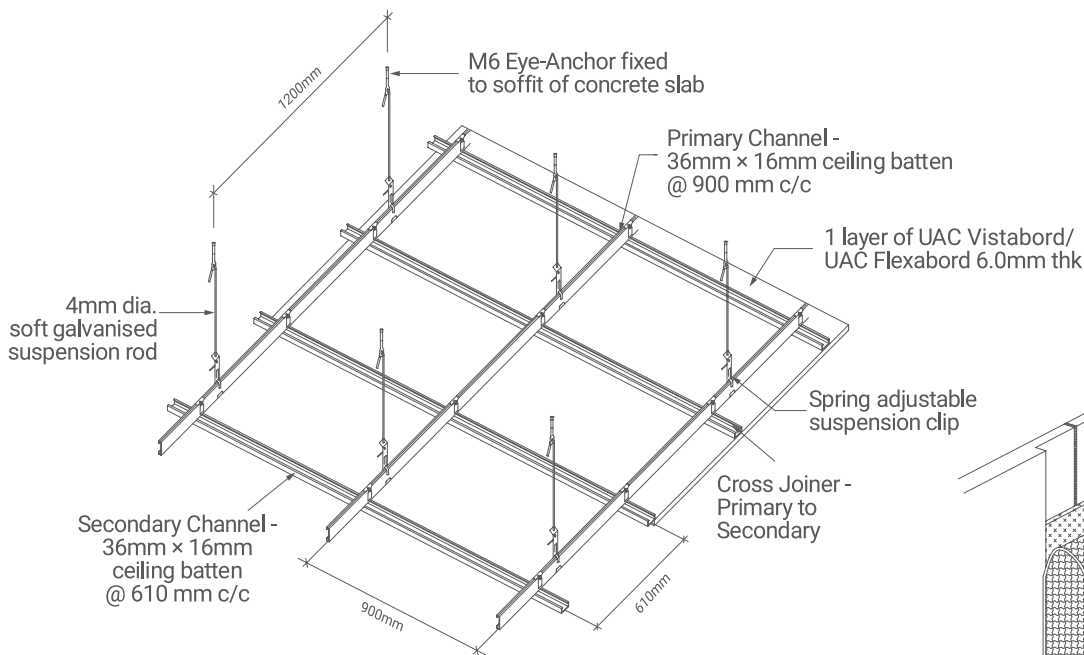

1. Fix the 4mm galvanised suspension rod to soffit of concrete slab by using M6 eye anchor at 1200mm centres maximum, parallel to the primary channel row. Adjust the level of the ceiling frame by using spring adjustable suspension clip.

2. Set up the galvanised iron metal studs to the level by lining up 36mm x 16mm x 0.42 BMT primary channel at 900mm centers maximum and 36mm x 16mm x 0.42 BMT secondary channel at 600mm centers maximum. Fix the cross joiners at the primary channel at 600mm centers maximum. Then, snap fit the secondary channel into the cross joiners.

3. Screw fix the UAC Flexabord/UAC Vistabord 6.0mm directly underside of secondary channel.

4. Seal the gaps between board joints and patch the screw points using UAC Jointing Compound or cementitious jointing compound.

5. Apply the 50mm width perforated paper tape or fibre mesh tape after applying the first layer of UAC Jointing Compound or cementitious jointing compound with 70mm width at the recessed edges of the boards. Then, flush joint the second layer with 200mm width, followed by the third layer of 250mm width.

6. Apply paint after the flush jointing process.

Note: Internal pressure is not taken into consideration in the design. Kindly refer to UAC representative for framing spacing and configuration in accordance the required design criteria.

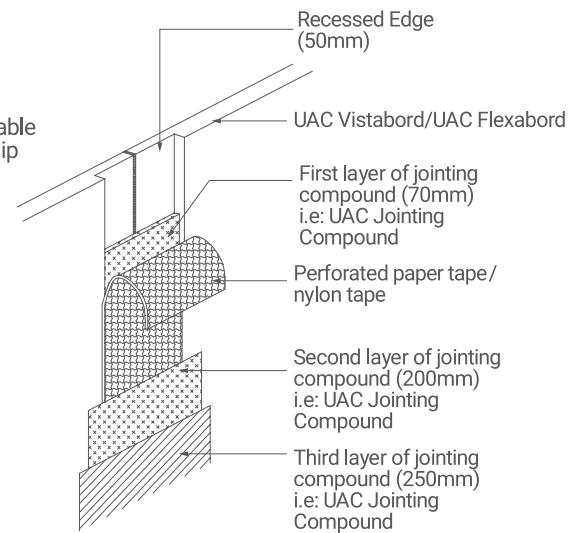

TYPICAL FLUSH JOINT DETAIL

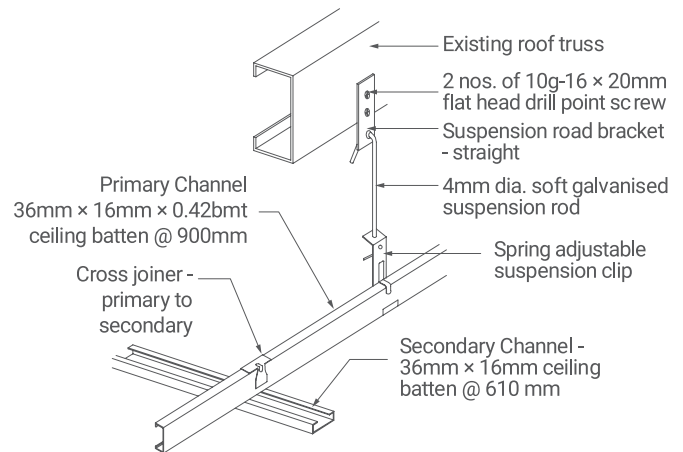

FOR ROOF TRUSS FIXING DETAIL

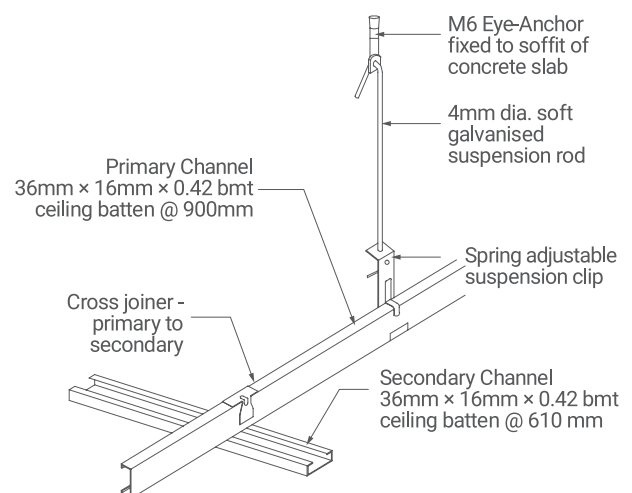

FOR CONCRETE FIXING DETAILS

B. TYPICAL DETAIL FOR EXTERNAL CEILING SYSTEM (SCREW FIXED)

1. For typical ceiling with drop less than 1500mm, fix the 51mm × 35mm × 0.75 BMT suspension channel (C-stud) to soffit of concrete slab by using M6 anchor bolt at 1200mm centres maximum, parallel to the primary channel (C-stud) row. Adjust the level of the ceiling frame before screw fixing to the primary channel.

2. Set up the galvanised iron metal studs to the level by up 51mm × 35mm × 0.75 BMT primary channel (C-stud) at 1000mm centres maximum and 50mm × 28mm ceiling batten 0.50 BMT@406mm screw fixed to the primary channel with 2 nos. of self-drilling screw.

3. Screw fix the UAC Flexabord/UAC Vistabord 6.0mm or 9.0mm directly to the underside of secondary channel.

4. Seal the gaps between board joints and patch the screw points using UAC Jointing Compound or cementitious jointing compound.

5. Apply the 50mm width perforated paper tape or the fibre mesh tape after applying the first layer of UAC Jointing Compound or cementitious jointing compound with 70mm width at the recessed edges of the boards. Then, flush joint the second layer with 200mm width, followed by the third layer of 250mm width.

6. Apply paint after the flush jointing process.

Note: Kindly refer to UAC representative for framing spacing and configuration in accordance the required design criteria.

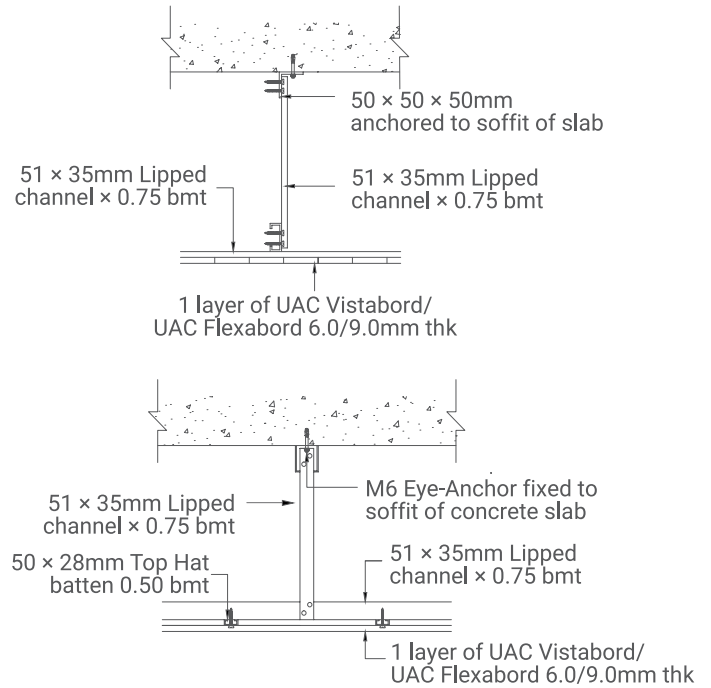

TYPICAL SECTION OF
CEILING BATTEN & SUSPENSION

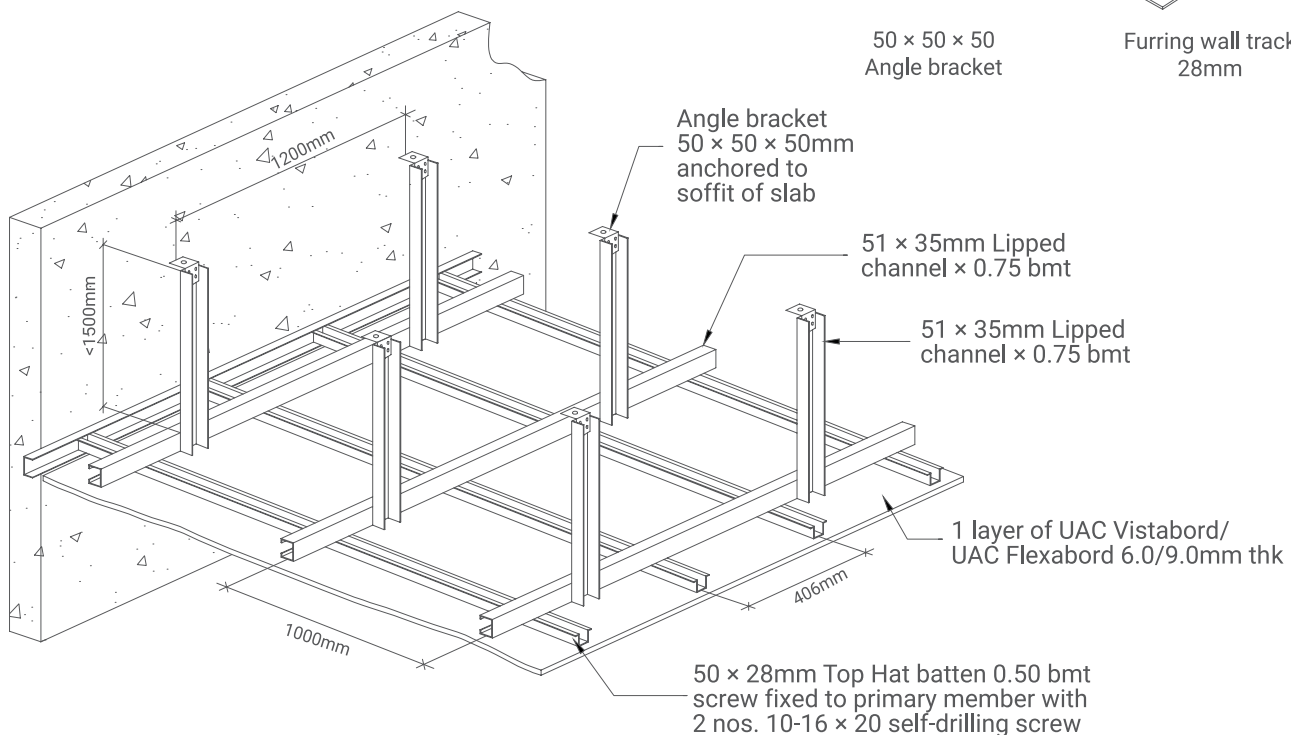
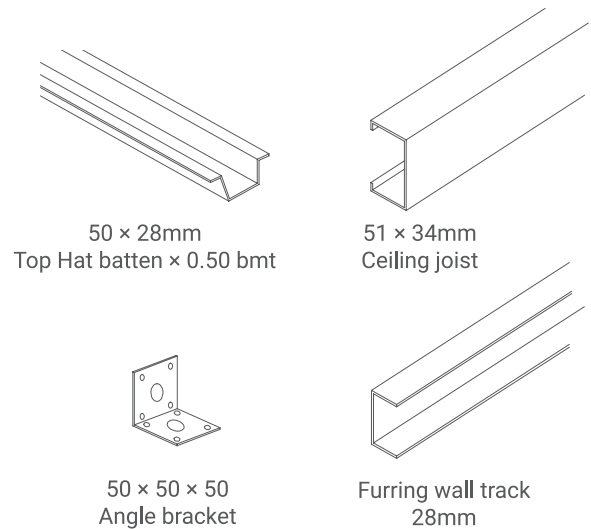

C. TYPICAL DETAIL FOR FIXING CEILING SYSTEM (CLIP FIXED / SCREW FIXED)

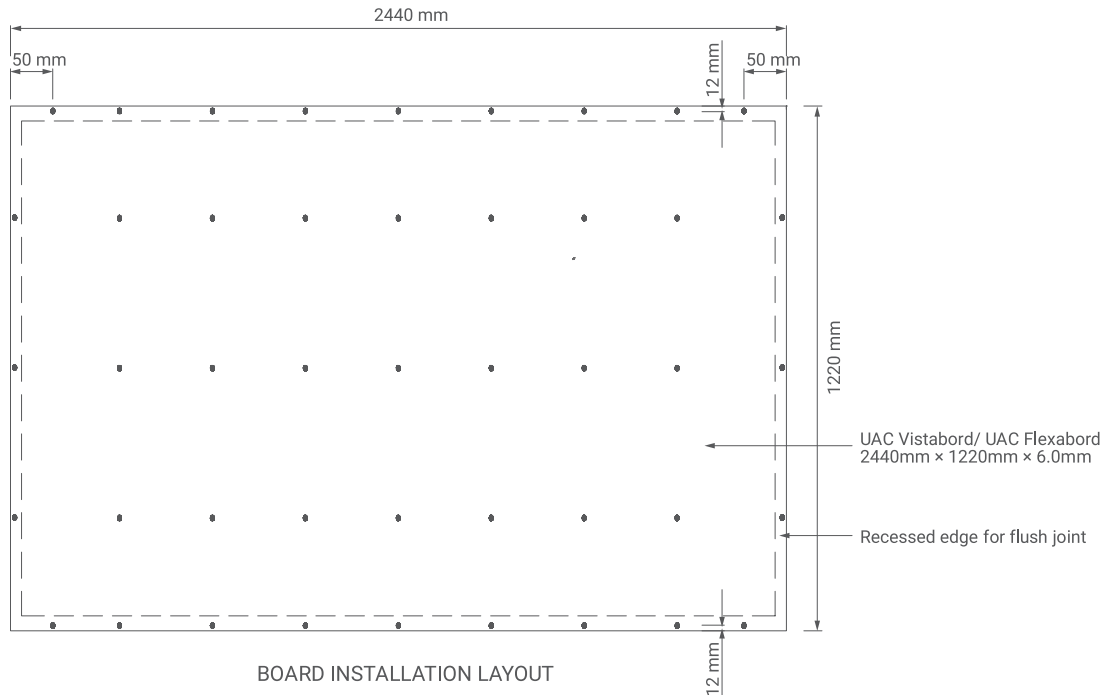

1. Fix the UAC Flexabord/UAC Vistabord to light gauge galvanised steel framing member. The galvanised steel framing thickness should be 0.42 BMT to 0.75 BMT. For internal ceiling, the recommended ceiling joist and runner spacing are 610mm and 900mm centres maximum, respectively. For external ceiling, the recommended ceiling joist and runner spacing are 406mm and 1000mm centres maximum, respectively.

2. Fix the fasteners along intermediate studs at approximately 300mm centres maximum and along sides of boards at approximately 300mm centres maximum and do not screw fix the board to the top and bottom runners/tracks or all noggings. Fasteners should not be less than 15mm from board edges and 50mm from corners.

3. Fill the fastener points with UAC Jointing Compound and sand the touch-up areas using 100 grit sand paper.

Internal ceiling: recommended UAC Flexabord/UAC Vistabord 6.0mm thick.

External ceiling: recommended UAC Flexabord/UAC Vistabord 6.0mm or 9.0mm thick.

4. Metal Frame: Fix the UAC Flexabord/UAC Vistabord 6.0mm or 9.0mm thick to the 0.42 BMT to 0.75 BMT galvanised light gauge steel section by using self-drilling wing tek screw. The gap is about 3mm wide and seal the gaps between board joints and patch the screw points using UAC Jointing Compound or cementitious jointing compound.

5. Flush Jointing Process: Apply the 50mm width perforated paper tape or fibre mesh tape after applying the first layer of UAC Jointing Compound or cementitious jointing compound with 70mm width at the recessed edges of the boards. Then, flush joint the second layer with 200mm width, followed by the third layer of 250mm width. Apply paint after the flush jointing process.

Note: Kindly refer to UAC representative for frame spacing and configuration in accordance the required design criteria.

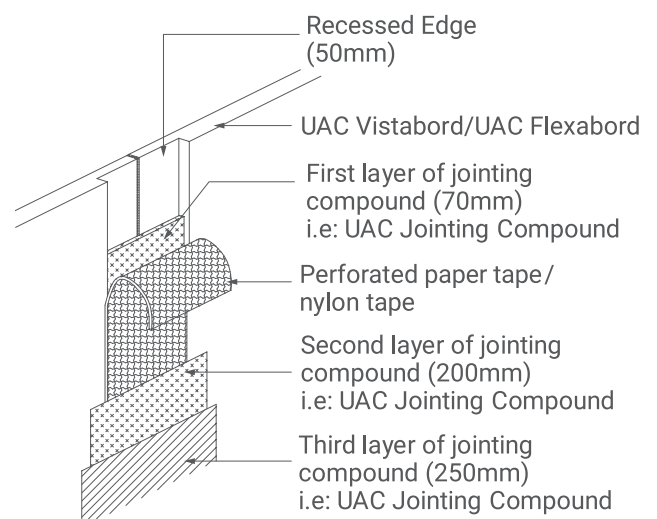
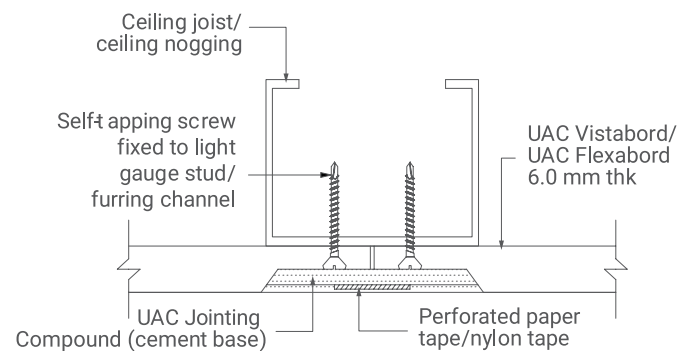

TYPICAL FLUSH JOINT DETAIL

WALL

A. TYPICAL DETAIL WALL FIXING

UAC Vistabord/UAC Flexabord is used as internal and external drywall systems. Install UAC Vistabord/UAC Flexabord on both sides of 76mm x 0.55 BMT galvanised steel studs at 610mm centres max. Horizontal noggings can be fixed at 1220mm centres max.

a. Fixing – untiled

Fasteners should not be placed less than 12mm from sheet edges and 50mm from corners. Fix the fasteners at 200mm centres maximum around the perimeter of the sheet, and 200mm centres maximum at the intermediate of the sheet.

b. Fixing – tiled

For the drywall with tiles, fix the fasteners at 200mm centres maximum around the perimeter of the sheet, and 200mm centres maximum at the intermediate of the sheet.

Screw points and board joints to be flush-jointed with UAC Jointing Compound/cementitious based jointing compound, together with fibre mesh tape/perforated paper tape. Internal and external drywall systems to be flush-jointed with UAC Jointing Compound/cementitious based jointing compound.

Flush Jointing process: Apply the 50mm width perforated paper tape or fibre mesh tape after applying the first layer of UAC Jointing Compound or cementitious jointing compound with 50mm width at the recessed edges of the boards. Then, flush joint the second layer with 200mm width, followed by the third layer of 250mm width. Apply paint after the flush jointing process.

Note: For the door and window openings, kindly refer to UAC representative for frame spacing and configuration in accordance the required design criteria.

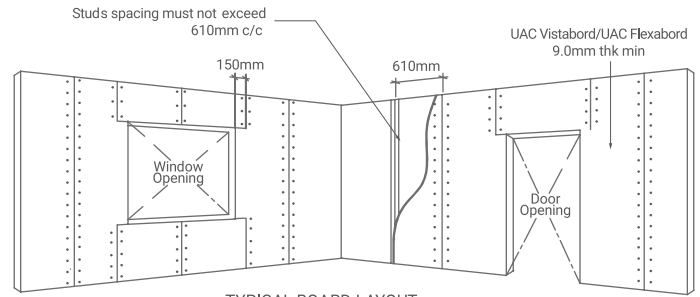

TYPICAL BOARD LAYOUT

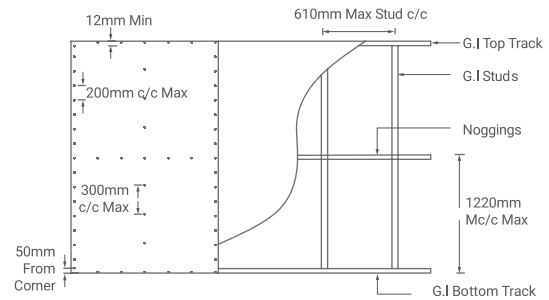

NAIL OR SCREW FIXING INSTALLATION (UNTILED)

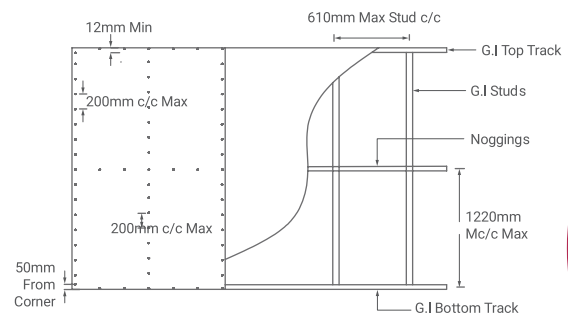

NAIL OR SCREW FIXING INSTALLATION (TILED)

B. TYPICAL DETAIL INTERNAL AND EXTERNAL WALL FIXING

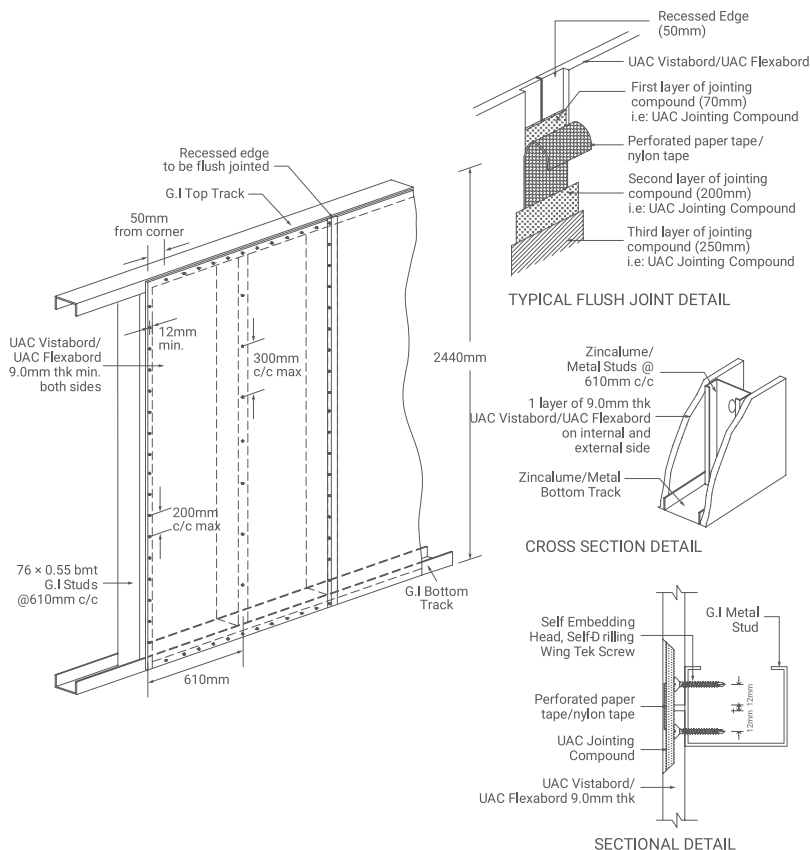

UAC Vistabord/UAC Flexabord is suitable to be used as internal and external drywall systems. The 94mm thick drywall system with 9.0mm thick UAC Vistabord/UAC Flexabord on both sides and 76mm x 0.55 BMT galvanised steel studs at 610mm centres maximum.

Screws shall not be placed less than 12mm from sheet edges and 50mm from corners. Screws should be fixed at 200mm centres maximum around the perimeter of the sheet, and 300mm centres maximum at the intermediate of the sheet. For tiling on one side of the board, stud to be spaced at 406mm. For tiling on both sides of the drywall, studs to be spaced at 305mm.

All fastener points and board joints are to be flush-jointed with UAC Jointing Compound/cementitious based jointing compound, together with fibre mesh tape/ perforated paper tape. Internal and external drywall systems to be flush-jointed with UAC Jointing Compound/cementitious based jointing compound.

Flush Jointing Process: Apply the 50mm width perforated paper tape or fibre mesh tape after applying the first layer of UAC Jointing Compound with 70mm width at the recessed edge of the boards. Then, flush joint the second layer with 200mm width, followed by the third layer of 250mm width. Apply paint after the flush jointing process.

Note: For the door and window openings, kindly refer to UAC representative for framing spacing and configuration in accordance the required design criteria.